

ADA GRADING AND PAVING IMPROVEMENT PLANS

FOR
COACHELLA VALLEY MOSQUITO AND VECTOR CONTROL DISTRICT

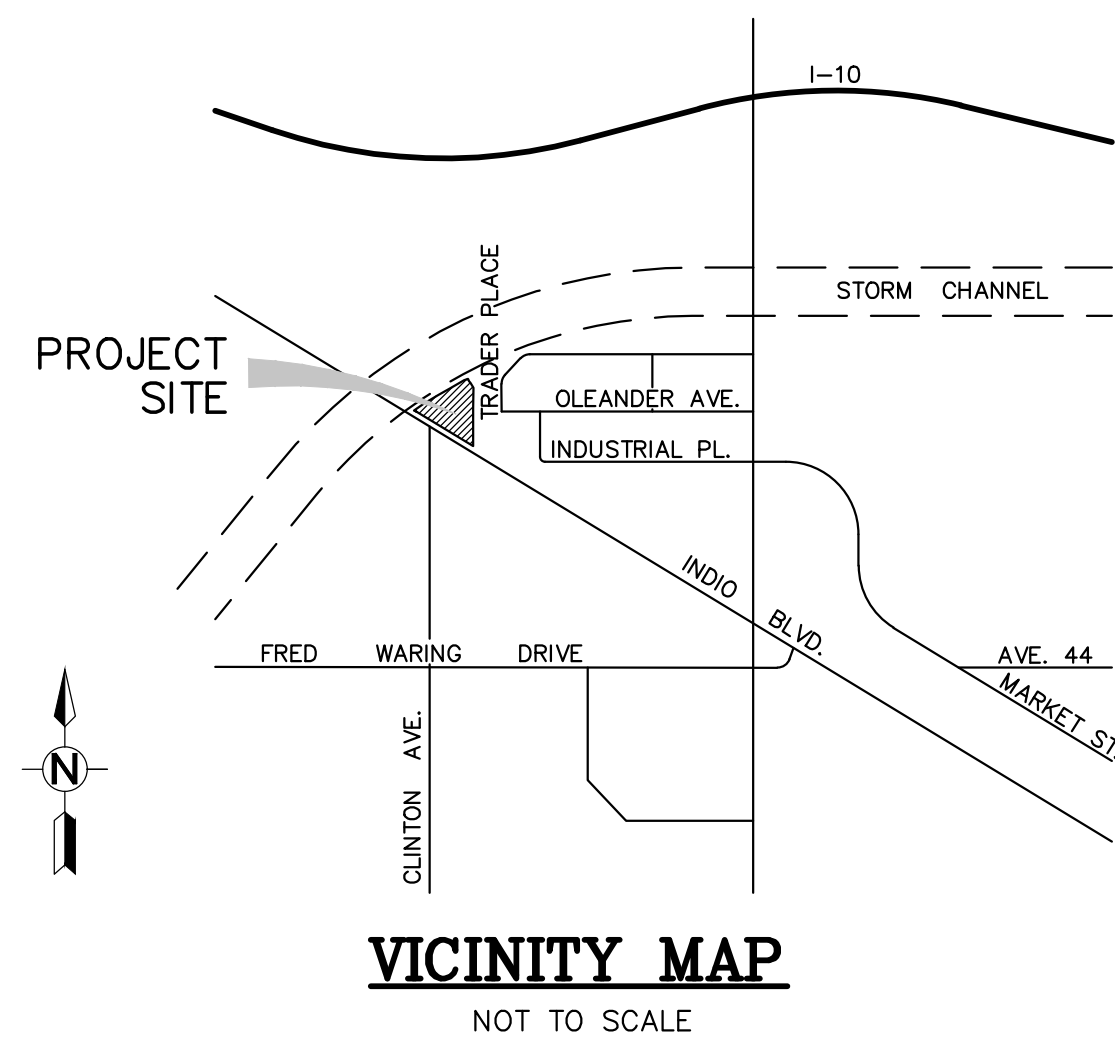

PAVING NOTES

1. INSPECTIONS REQUIRE A MINIMUM OF TWENTY-FOUR (24) HOURS NOTICE.
2. THE EXISTENCE AND LOCATION OF ANY UNDERGROUND UTILITIES OR STRUCTURES SHOWN ON THESE PLANS ARE OBTAINED BY A SEARCH OF AVAILABLE RECORDS. TO THE BEST OF OUR KNOWLEDGE, THERE ARE NO EXISTING UTILITIES EXCEPT THOSE SHOWN ON THESE PLANS. THE CONTRACTOR MUST ASK THE UTILITY COMPANIES TO FIELD LOCATE ALL UNDERGROUND LINES. THE CONTRACTOR IS REQUIRED TO TAKE ALL PRECAUTIONARY MEASURES TO PROTECT THE UTILITIES SHOWN, AND ANY OTHER LINES OR STRUCTURES NOT SHOWN ON THESE PLANS, AND IS RESPONSIBLE FOR THE PROTECTION OF ANY DAMAGE TO THESE LINES OR STRUCTURES.
3. THE CONTRACTOR IS RESPONSIBLE FOR ALL EARTHWORK AND GRADING WITHIN CONSTRUCTION AREA PER CITY OF INDIO STANDARD SPECIFICATIONS. THE COMPENSATION FOR ALL EARTHWORK IN THIS PROJECT ARE INCLUDED IN THE VARIOUS ITEMS IN THIS CONTRACT AND NO OTHER ALLOWANCE WILL BE CONSIDERED.
4. ASPHALT CONCRETE PAVING SHALL BE FURNISHED IN ACCORDANCE WITH SECTION 39 OF THE STANDARDS SPECIFICATION OF THE STATE OF CALIFORNIA. EXCEPT AS FOLLOWS: THE COMBINED MINERAL AGGREGATE SHALL CONFORM TO THE GRADING SPECIFIED FOR 1/2 INCH, MAXIMUM GRADING FOR THE BASE COURSE, AND 3/8 INCH MAXIMUM MEDIUM GRADING FOR THE SURFACE COURSE. BITUMINOUS BINDER TO BE MIXED WITH THIS MINERAL AGGREGATE SHALL BE STEAM REFINED, PAVING ASPHALT GRADE AR 4000 CONFORMING TO SECTION 92 OF THE STANDARD SPECIFICATION OF THE STATE OF CALIFORNIA.
5. THE CONTRACTOR SHALL NOTIFY UNDERGROUND SERVICE ALERT PRIOR TO EXCAVATION.
6. THE CONTRACTOR SHALL TIE OUT ALL WATER VALVES, MANHOLE COVERS AND STANDARD MONUMENTS ON THE CURB PRIOR TO CONSTRUCTION, AND PRESENT A COPY OF TIES TO CITY.
7. RELATIVE COMPACTION OF NOT LESS THAN NINETY FIVE PER CENT (95%) SHALL BE OBTAINED WITHIN THE TOP 12" OF THE ROADBED.
8. THE CONTRACTOR SHALL VERIFY THE LOCATIONS OF EXISTING CONDITIONS, ESPECIALLY THE UTILITIES, BEFORE BIDDING THIS PROJECT.
9. LOCATIONS OF EXISTING UTILITIES CAN ONLY BE APPROXIMATE, CONTRACTOR SHALL BE RESPONSIBLE TO DETERMINE EXACT LOCATIONS BEFORE CONSTRUCTION BEGINS.
10. ASPHALT CONCRETE PAVING SHALL BE DONE IN TWO LIFTS FOR 3 INCHES THICKNESS. THE FIRST LIFT SHOULD BE 2 INCHES WITH 1/2 INCH MAXIMUM MEDIUM GRADING AND THE SECOND LIFT SHOULD BE 1 INCH THICK WITH 3/8 INCH MAXIMUM MEDIUM GRADING WHILE FOR 2-1/2 INCHES THICKNESS, THE FIRST LIFT SHALL BE 1-1/2 INCH MAXIMUM MEDIUM GRADING. THE SECOND LIFT SHOULD BE 1 INCH WITH 3/8 INCH MAXIMUM MEDIUM GRADING.
11. PRIOR TO THE PLACEMENT OF A.C. PAVEMENT AN APPLICATION OF WEED CONTROL SHALL BE APPLIED PER CAL TRANS STD.

UTILITY COMPANIES

WATER	CITY OF INDIO	(760) 342-6530
SEWER	VALLEY SANITARY DISTRICT	(760) 347-2356
ELECTRIC	IMPERIAL IRRIGATION DISTRICT	(800) 750-2605
TELEPHONE	VERIZON	(760) 422-4233
GAS	SOUTHERN CALIFORNIA GAS COMPANY	(760) 422-4133
CABLE T.V.	SPECTRUM	(760) 340-1312
OIL	SOUTHERN PACIFIC PIPE LINE	(760) 321-5307
IRRIGATION	COACHELLA VALLEY WATER DISTRICT	(760) 398-2651

OWNER & DEVELOPER

COACHELLA VALLEY MOSQUITO AND VECTOR CONTROL DISTRICT 43-420 TRADER PLACE
INDIO, CA. 92201
(760) 342-8287

PROJECT ADDRESS

43-420 TRADER PLACE
INDIO, CALIFORNIA 92201
BASIS OF BEARINGS IS TAKING ALONG THE MONUMENTED CENTERLINE OF TRADER PLACE DRIVE, BEING N00°00'26"E

BASIS OF BEARINGS

THE BASIS OF BEARINGS IS TAKING ALONG THE MONUMENTED CENTERLINE OF TRADER PLACE DR. BEING N 00°00'26" E

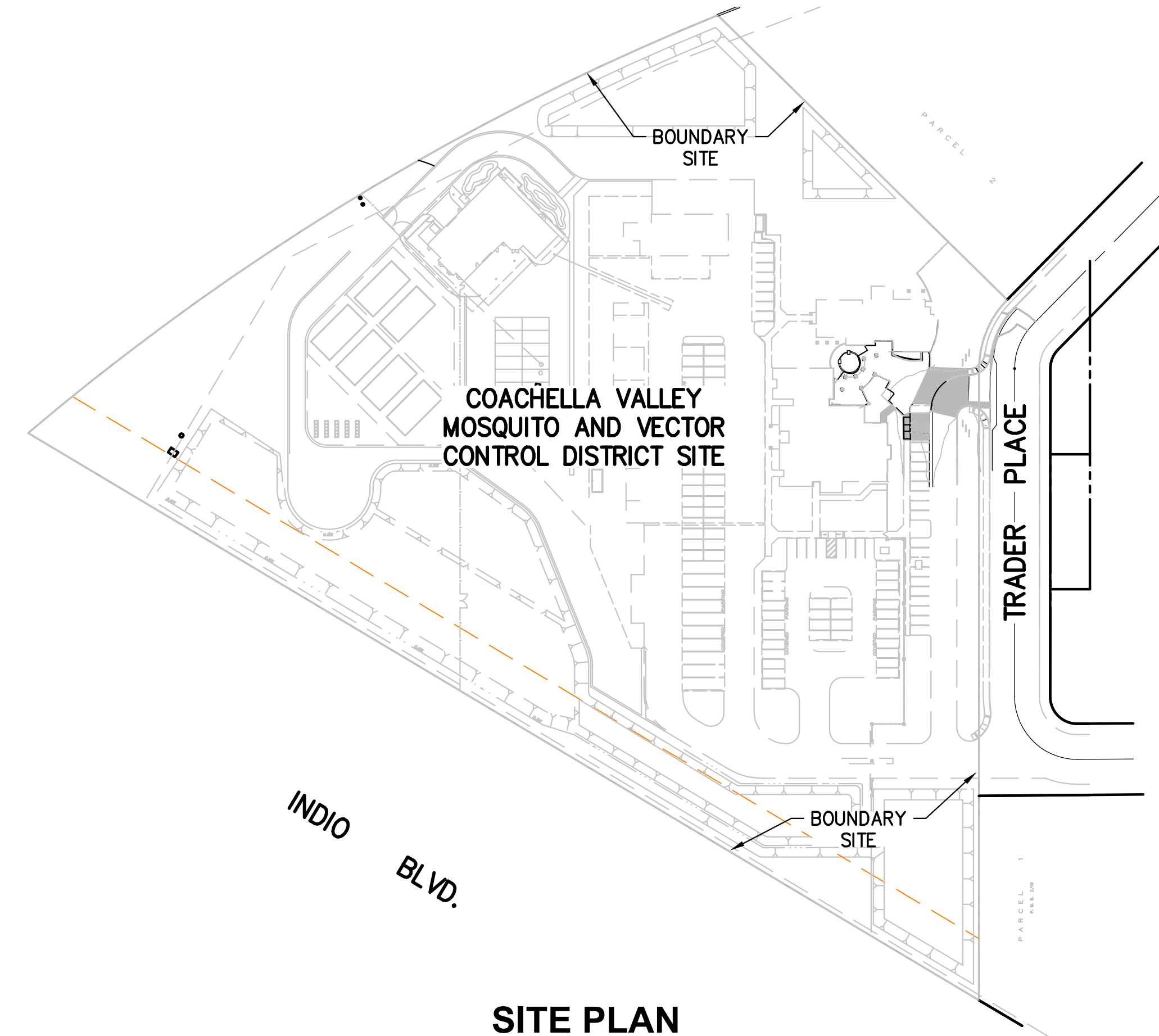

LEGEND

→····→	FLOWLINE OF SWALE
TC	TOP OF CURB
FL	FLOWLINE
FF	FINISHED FLOOR
FS	FINISHED SURFACE
TP	TOP OF PAVEMENT
FG	FINISHED GRADE
PE	PAD ELEVATION
(50.40)	EXIST. ELEVATION
60.07	PROPOSED ELEVATION

SHEET INDEX

SHT #	DESCRIPTION
1	TITLE SHEET
2	DEMOLITION PLAN
3	GRADING PLAN
4	DETAILS & SECTIONS

GENERAL NOTES

1. ALL WORK SHALL CONFORM TO THE CITY OF INDIO STANDARDS AND SPECIFICATIONS FOR PUBLIC WORKS CONSTRUCTION CURRENT EDITION OR AS DIRECTED BY CITY ENGINEER AND THESE PLANS.
2. INSPECTION OF GRADING SHALL BE IN ACCORDANCE WITH ENGINEERING GRADING REQUIREMENTS OF THE UNIFORM BUILDING CODE, APPENDIX 33, 1997 EDITION.
3. A GRADING PERMIT FROM THE CITY OF INDIO SHALL BE OBTAINED PRIOR TO THE COMMENCEMENT OF GRADING.
4. AN ENCROACHMENT PERMIT FROM THE CITY OF INDIO ENGINEERING SERVICES DEPARTMENT SHALL BE OBTAINED PRIOR TO ANY GRADING WITHIN THE RIGHT-OF-WAY OR CONSTRUCTION ON THE STREET.
5. ON-SITE SUB-BASE OR BASE WITHIN TRAVEL WAY MUST BE COMPACTED TO A RELATIVE 90%.
6. AREA TO RECEIVE FILL SHALL BE PROPERLY PREPARED AND APPROVED BY THE SOIL ENGINEER PRIOR TO PLACING FILL.
7. ALL GRADING WORK SHALL BE DONE WHILE TAKING ANY REASONABLE, NECESSARY STEPS TO PREVENT CREATION OF NUISANCE INCLUDING BUT NOT LIMITED TO SPILLAGE, DUST, EROSION, AND NOISE CONTROL.
8. THE LOCATION OF EXISTING SURFACE AND UNDERGROUND UTILITIES ARE IN AN APPROXIMATE WAY ONLY. THE CONTRACTOR SHALL DETERMINE THE EXACT LOCATION OF ALL EXISTING UTILITIES BEFORE COMMENCING WORK. THE CONTRACTOR AGREES TO BE FULLY RESPONSIBLE FOR ANY AND ALL DAMAGES TO SURFACE AND UNDERGROUND UTILITIES. THE CONTRACTOR SHALL CALL UNDERGROUND SERVICE ALERT TWO DAYS PRIOR TO ANY EXCAVATION 91-800-227-2600).
9. ANY IMPROVEMENT INSTALLED WITHOUT INSPECTION BY ENGINEERING SERVICES DEPARTMENT WILL BE SUBJECT TO REMOVAL.
10. INSPECTIONS REQUIRE MINIMUM OF TWENTY FOUR (24) HOUR NOTICE.
11. THE CONTRACTOR SHALL BE RESPONSIBLE FOR THE CLEARING OF THE PROPOSED WORK AREA, RELOCATION AND COSTS OF ANY AND ALL UTILITIES INVOLVED. CONTRACTOR MUST INFORM THE CITY OF INDIO ENGINEERING DEPARTMENT OF START OF CONSTRUCTION AT LEAST FORTY-EIGHT (48) HOURS PRIOR TO THE BEGINNING OF CONSTRUCTION. TELEPHONE No. (760) 342-6530.
12. CONTRACTOR SHALL INSTALL STREET NAME SIGNS AND TRAFFIC CONTROL SIGNS. TYPE AND LOCATION SHALL BE APPROVED BY THE CITY ENGINEER.
13. ALL UNDERGROUND FACILITIES WITHIN STREET SECTIONS SHALL BE IN PLACE PRIOR TO BASE COURSE INSTALLATION WITH TRENCH COMPACTION TESTED AND APPROVED.
14. THE FINAL OR SURFACE LAYER OF ASPHALT CONCRETE SHALL NOT BE PLACED UNTIL ALL ON-SITE IMPROVEMENTS HAVE BEEN COMPLETED, INCLUDING EARTHWORK.
15. NOTHING IN THESE PLANS SHALL RELIEVE THE CONTRACTOR FROM OBTAINING NECESSARY PERMITS AS REQUIRED BY THE CITY OF INDIO MUNICIPAL CODE. OR THAT OF OTHER GOVERNING AGENCIES.
16. CONTRACTOR SHALL NOTIFY RESPECTIVE UTILITY COMPANIES WHERE APPURTENANCES ARE WITHIN RIGHT-OF-WAY AND/OR OBSTRUCTING CONSTRUCTION SO THAT THEY MAY BE RELOCATED BY APPROPRIATE UTILITY COMPANY.
17. ANY CHANGE IN THE WORK SHOWN HEREON SHALL BE SUBJECT TO THE APPROVAL OF THE CITY OF INDIO CITY ENGINEER.
18. A REGISTERED CIVIL ENGINEER OR LICENSED SURVEYOR SHALL SUBMIT CERTIFICATION OF BUILDING PAD ELEVATION WHERE SPECIFIC ELEVATIONS ARE REQUIRED.
19. APPROVAL OF THESE PLANS BY THE CITY OR ITS AGENT DOES NOT RELIEVE THE DESIGN ENGINEER AND THE APPLICANT FROM THE RESPONSIBILITY FOR THE CORRECTION OF ERRORS OR OMISSIONS DISCOVERED DURING CONSTRUCTION. UPON REQUEST BY THE CITY, THE APPROPRIATE PLAN REVISIONS SHALL BE PROMPTLY SUBMITTED TO THE CITY ENGINEER FOR REVIEW AND APPROVAL.
20. DUST CONTROL: AS SOON AS THE GRADING IS COMPLETED ON EACH SECTION, A TEMPORARY SPRINKLER SYSTEM SHALL BE SET UP AND THE AREA SEEDED WITH A COVER CROP SUCH AS BARLEY, RYE OR SUDAN GRASS, DEPENDING UPON THE SEASON. THE SOWING RATE SHALL NOT BE LESS THAN 150 LBS. PER ACRE FOR BARLEY AD RYE GRASS, AND 32 LBS. PER ACRE FOR SUDAN GRASS. WATERING SHALL CONTINUE UNTIL A GROWTH OF 8" MIN. HAS BEEN OBTAINED AND THE COVER CROP IS UNIFORM THROUGHOUT THE AREA. THIS SHALL APPLY TO ANY AREA DISTURBED BY THE DEVELOPER, THE DEVELOPER'S CONTRACTORS, SUB CONTRACTORS OR ANY OTHERS PERFORMING WORK RELATED TO THE PROJECT. ALL STOCK PILE, BORROW SITES AND HAUL ROADS SHALL BE TREATED IN A SIMILAR MANNER.
21. AFTER CLEARING, EXISTING GROUND SHALL BE SCARIFIED TO A MINIMUM OF 6" ON ENTIRE SITE UNTIL THE SURFACE IS FREE FROM UNEVEN FEATURES THAT WOULD TEND TO PREVENT UNIFORM COMPACTION BY THE EQUIPMENT USED.
22. ALL GRADING SHALL BE DONE IN ACCORDANCE WITH THE ENGINEERED GRADING REQUIREMENTS OF THE UNIFORM BUILDING CODE, APPENDIX 33, 1997 EDITION AND SOILS REPORT NO. LP03005 DATED 8/25/03 PREPARED BY LANDMARK CONSULTANTS, INC.
23. THE CONTRACTOR SHALL NOTIFY THE BUILDING AND SAFETY DEPARTMENT AT LEAST 24 HOURS IN ADVANCE OF REQUESTING FINISH LOT GRADE AND DRAINAGE INSPECTION. THIS INSPECTION MUST BE APPROVED PRIOR TO BUILDING PERMIT FINAL INSPECTION.
24. THE CITY OF INDIO ENGINEERING SERVICES DEPARTMENT WILL NOT GIVE ANY ASSURANCE THAT THIS PLAN IS COMPLETE AND THAT IT WILL MATCH EXISTING FIELD CONDITIONS.

C:\Email\Temp\COMDCD\14009_PGP.dwg Jul 06, 2021, 1:05pm

SEAL



PREPARED UNDER THE SUPERVISION OF:

CHARLES H. GREELY DATE
R.C.E. No. 69056 EXP. DATE: 06/30/22

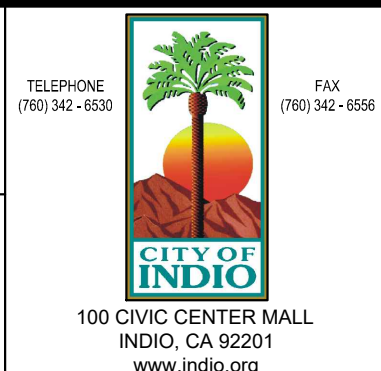

SCALE: AS SHOWN
BENCHMARK: (TEMPORARY BENCHMARK)
CENTER TOP OF EASTERLY CURB OF TRADER PLACE DRIVE AT THE BEGINNING OF CURVE (MARKED WITH A CONG. NAIL) OPPOSITE MAIN ENTRY TO COACHELLA VALLEY MOSQUITO AND VECTOR CONTROL DISTRICT OFFICES.
DATE: June, 2021
ELEV. = 505.38 NAVD88

CITY OF INDIO, STATE OF CALIFORNIA

GRADING & PAVING PLANS

TITLE SHEET

FOR: Coachella Valley Mosquito and Vector Control District

SHEET No.

1

OF 4 SHTS.

DEMOLITION NOTES

- SAWCUT EXISTING CONCRETE OR ASPHALT
- REMOVE AND REPLACE EXISTING ASPHALT
- REMOVE EXISTING CURB AND GUTTER.
- REMOVE AND REPLACE EXISTING CONCRETE
- REMOVE EXISTING BARRIER CURB.

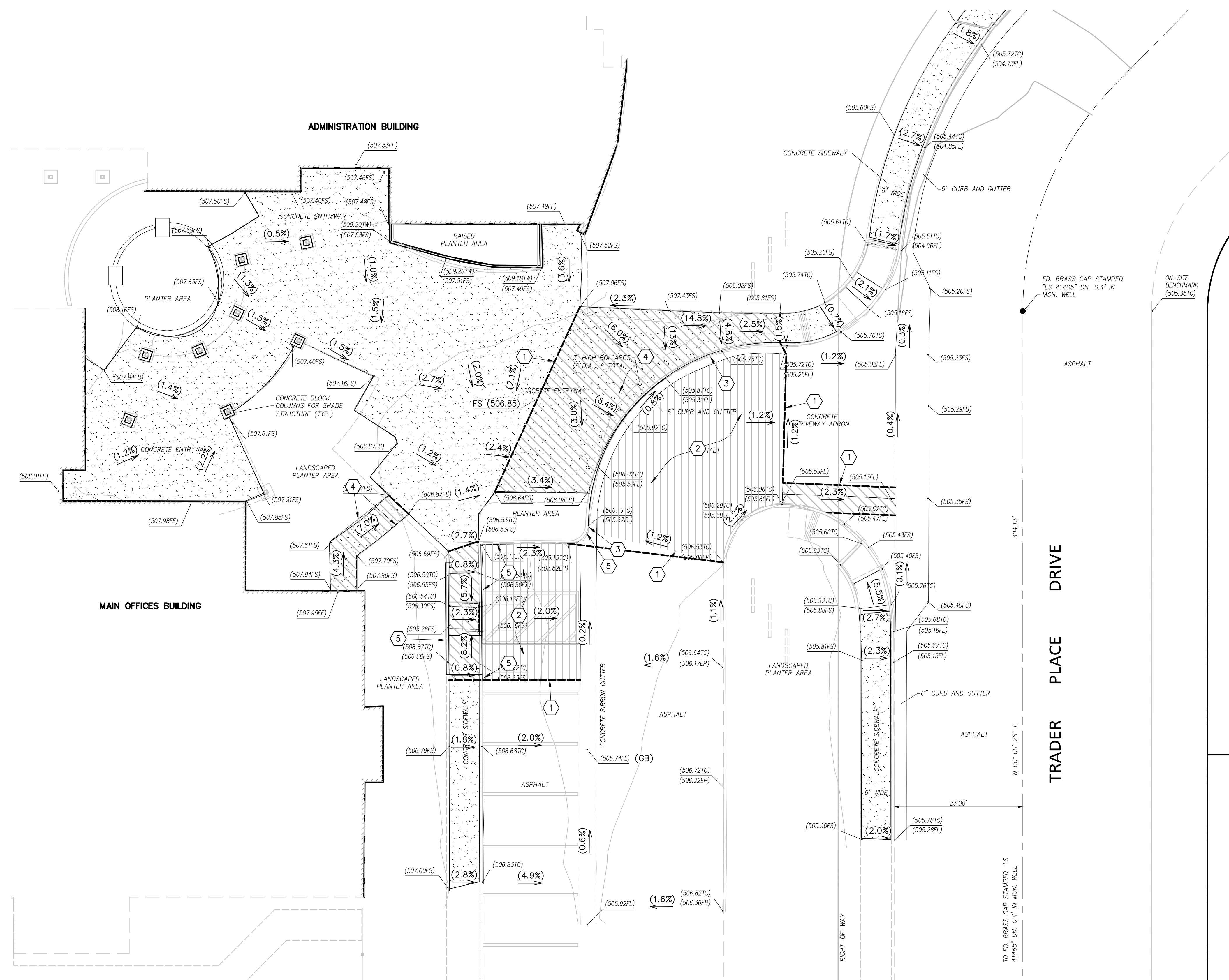

BASIS OF BEARINGS:
BASIS OF BEARINGS IS TAKING ALONG THE MONUMENTED CENTERLINE OF
TRADER PLACE DRIVE, BEING N00°00'28"E

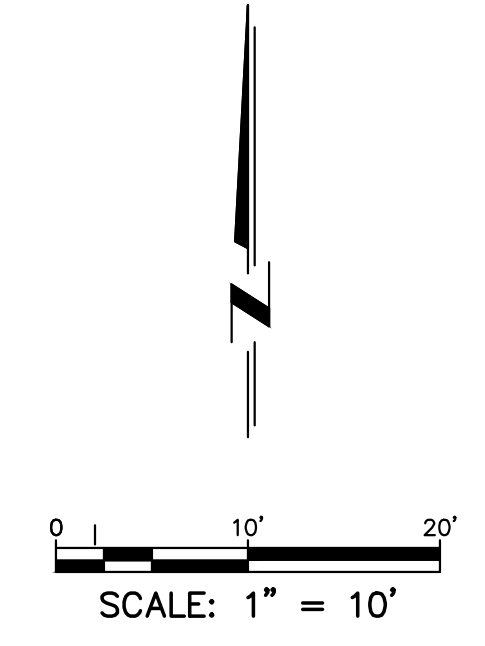

C:\Email\Temp\COM\CD\14009_PGP.dwg Jul 06, 2021, 3:05pm

DATE	BY	MARK	APPR.	DATE
ENGINEER		REVISIONS		
DRAWN BY: PV/AM		DESIGNED BY: AM/CHG		CHECKED BY: CHG

SEAL

PREPARED UNDER THE SUPERVISION OF:
CHARLES H. GREELY
R.C.E. No. 69056 EXP. DATE: 06/30/22

DUDEK Engineering, Planning, Environmental Sciences and Management Services

78075 Main St. Ste. 203G
La Quinta, CA 92253
Tel. 760.341-6660

SCALE: AS SHOWN
DATE: June, 2021
BENCHMARK: (TEMPORARY BENCHMARK)
CENTER TOP OF EASTERLY CURB OF TRADER PLACE DRIVE AT THE BEGINNING OF CURVE (MARKED WITH A CONG. NAIL) OPPOSITE MAIN ENTRY TO COACHELLA VALLEY MOSQUITO AND VECTOR CONTROL DISTRICT OFFICES.
ELEV. = 505.38 NAVD88

CITY OF INDO, STATE OF CALIFORNIA

GRADING & PAVING PLANS

DEMOLITION PLAN

FOR: Coachella Valley Mosquito and Vector Control District

SHEET No. **2**

OF **—** SHTS.

CONSTRUCTION NOTES

- ① SAWCUT EXISTING CONCRETE OR ASPHALT
- ② BITUMINOUS PAVED AREAS SHALL BE 2" COMPACTED DEPTH ASPHALT CONCRETE TYPE "B" OVER A MINIMUM 6" COMPACTED DEPTH AGGREGATE BASE. PRIOR TO PLACEMENT, SUBGRADE SHALL BE PROOF-ROLLED AND APPROVED BY PROJECT GEOTECHNICAL ENGINEER.
- ③ CONSTRUCT RAMP AND HANDRAIL PER DETAIL 3 SHOWN HEREON.
- ④ CONSTRUCT STANDARD 24" CURB AND GUTTER AS PER CITY OF INDO DRAWING NUMBER SS-4.
- ⑤ 3' VALLEY GUTTER PER DETAIN X SHOWN ON SHEET X.
- ⑥ CONSTRUCT 4" THICK SIDEWALK PER CITY OF INDO STD. DWG. 132
- ⑦ CONSTRUCT CURB RAMP CASE C PER CITY OF INDO STD. DWG. 136
- ⑧ JOINT CONNECTION, PER DETAIL SHOWN HEREON

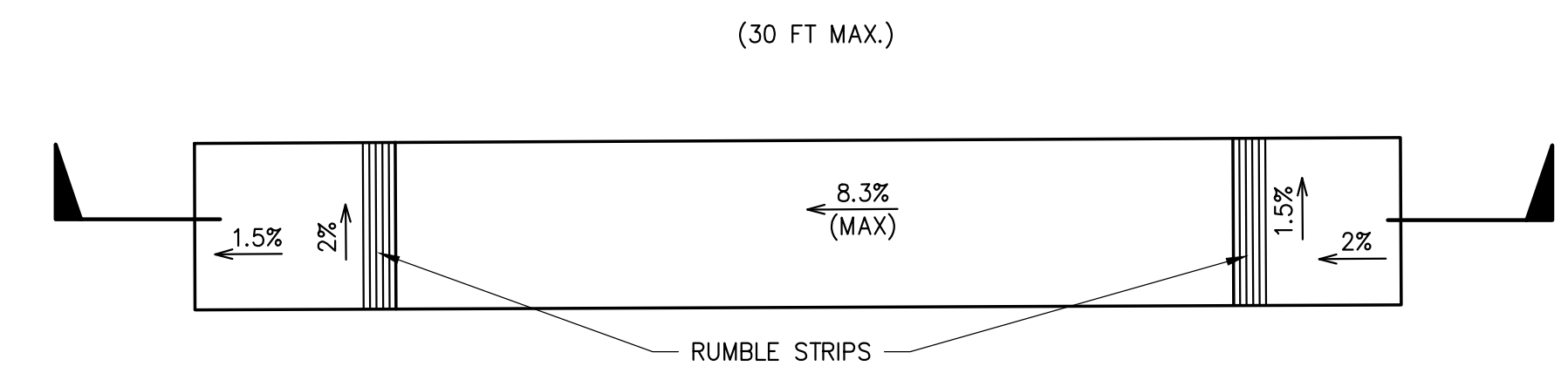

DETAIL 3

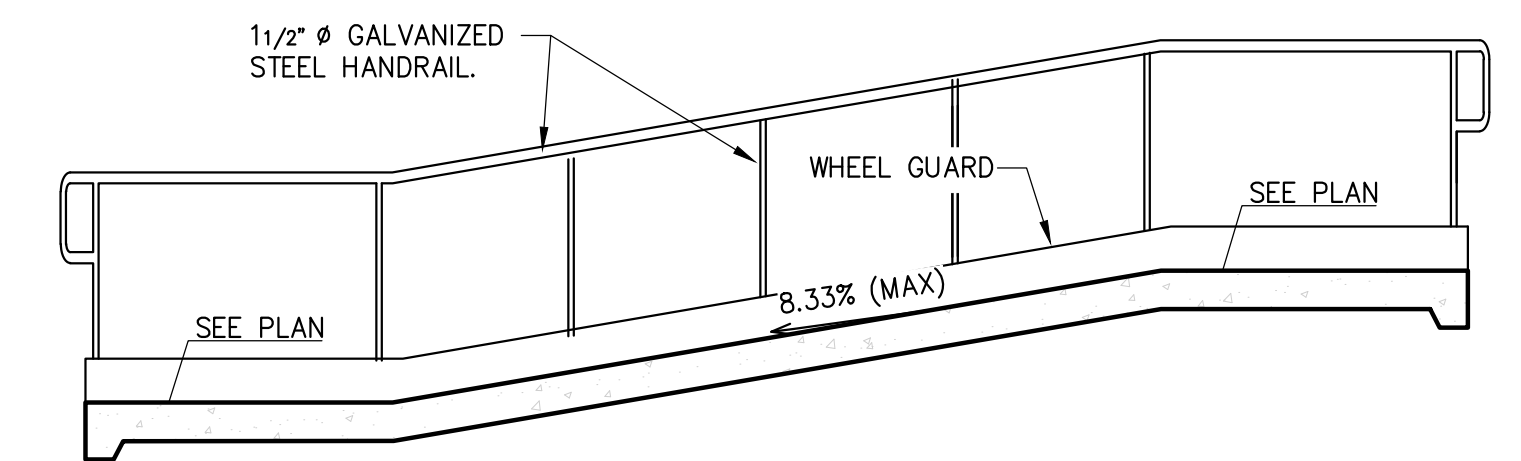

SECTION A

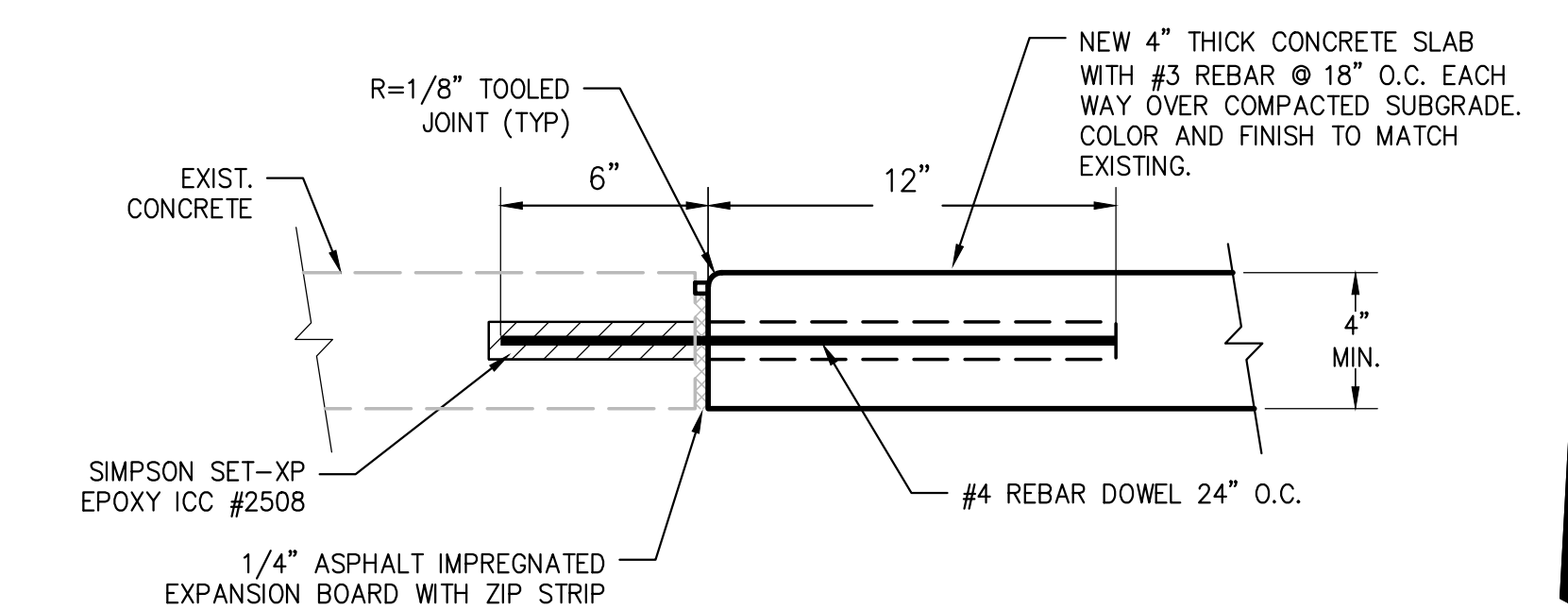

JOINT TO EXISTING SIDEWALK DETAIL

N. T. S.

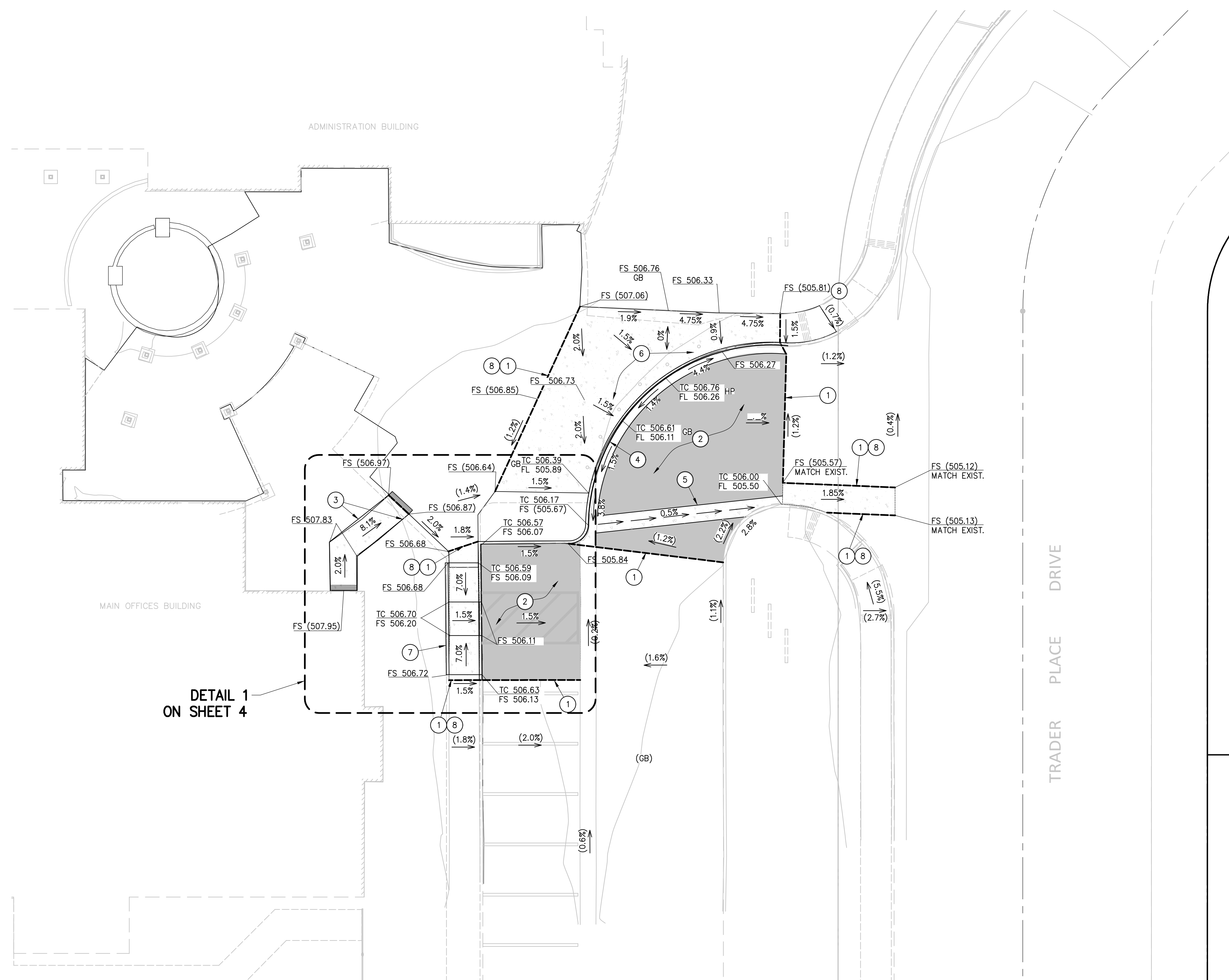
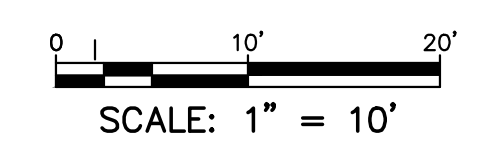

BASIS OF BEARINGS:
BASIS OF BEARINGS IS TAKING ALONG THE MONUMENTED CENTERLINE OF TRADER PLACE DRIVE, BEING N00°00'28"E

C:\Email\Temp\COM\CD\14009 PGP.dwg Jul 06, 2021, 1:07pm

DATE	BY	MARK	REVISIONS	APPR.	DATE

DRAWN BY: PV/AM DESIGNED BY: AM/CHG CHECKED BY: CHG

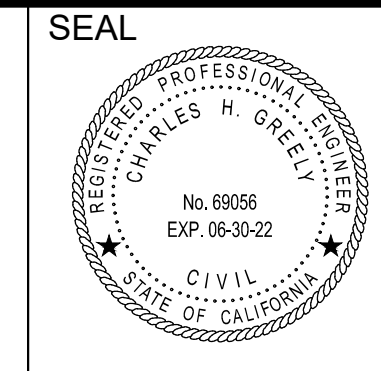

PREPARED UNDER THE SUPERVISION OF:
CHARLES H. GREELY DATE: 06/30/22
R.C.E. No. 69056 EXP. DATE: 06/30/22

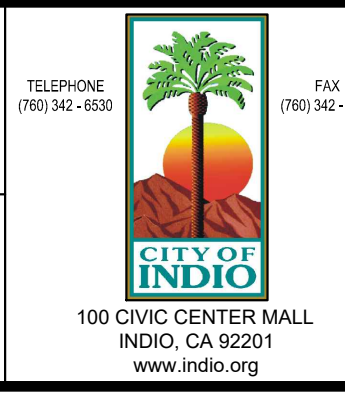

DUDEK Engineering Planning
Environmental Sciences and Management Services
78075 Main St. Ste. 203G
La Quinta, CA 92253
Tel. 760.341-6660

SCALE: AS SHOWN BENCHMARK: (TEMPORARY BENCHMARK)
DATE: June, 2021 CENTER TOP OF EASTERLY CURB OF TRADER PLACE DRIVE AT THE BEGINNING OF CURVE (MARKED WITH A CONG. NAIL) OPPOSITE MAIN ENTRY TO COACHELLA VALLEY MOSQUITO AND VECTOR CONTROL DISTRICT OFFICES.
ELEV. = 505.38 NAVD88

CITY OF INDO, STATE OF CALIFORNIA
GRADING & PAVING PLANS

GRADING PLAN

FOR: **Coachella Valley Mosquito and Vector Control District**

SHEET No. **3**
OF **—** SHTS.

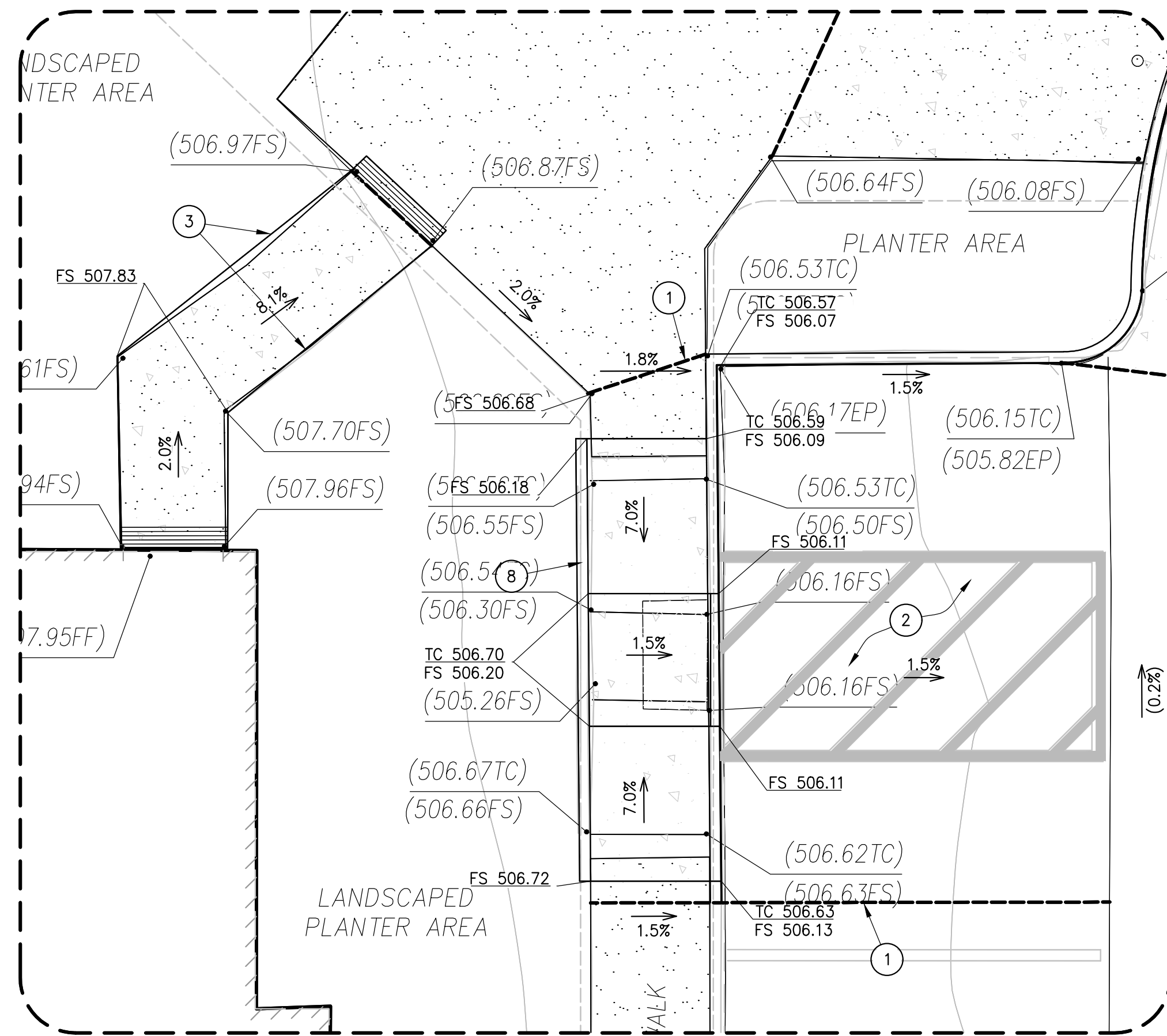

DETAIL 1

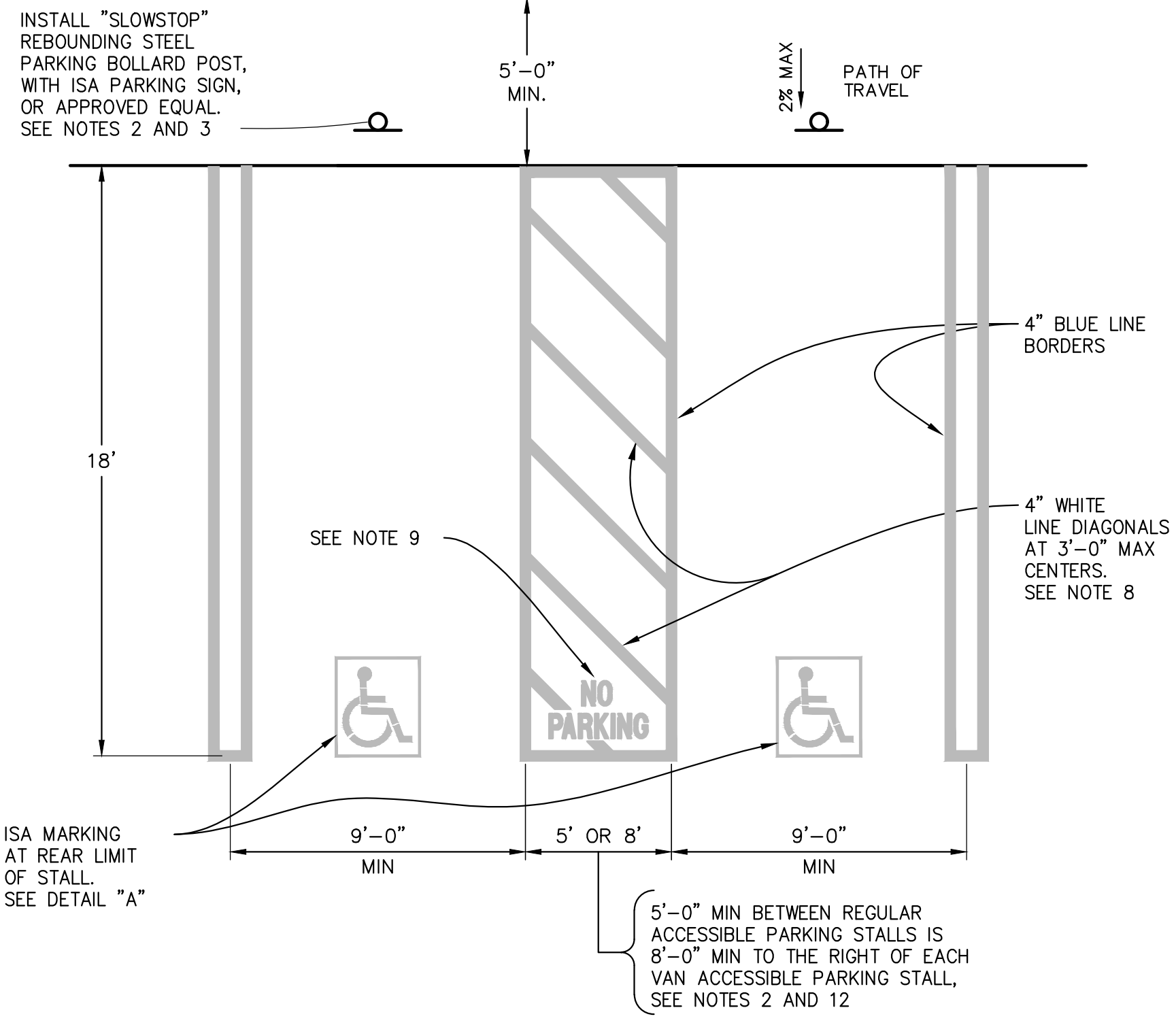

DOUBLE PARKING STALL

N.T.S.

NOTES:

- ACCESSIBLE PARKING SPACES SERVING A PARTICULAR BUILDING SHALL BE LOCATED ON THE SHORTEST ACCESSIBLE ROUTE OF TRAVEL FROM ADJACENT PARKING TO AN ACCESSIBLE ENTRANCE. IN PARKING FACILITIES THAT DO NOT SERVE A PARTICULAR BUILDING, ACCESSIBLE PARKING SHALL BE LOCATED ON THE SHORTEST ACCESSIBLE ROUTE OF TRAVEL TO AN ACCESSIBLE PEDESTRIAN ENTRANCE OF THE PARKING FACILITY.
- ONE IN EVERY SIX ACCESSIBLE OFF-STREET PARKING STALLS, BUT NOT LESS THAN ONE, SHALL BE SERVED BY AN ACCESSIBLE AISLE OF 8'-0" MINIMUM WIDTH AND SHALL BE SIGNED VAN ACCESSIBLE. THE R7-8B SIGN SHALL BE MOUNTED BELOW THE R99B (CA) PLAQUE OR THE R99C (CA) SIGN.
- IN EACH PARKING STALL, A CURB OR BUMPER SHALL BE PROVIDED AND LOCATED TO PREVENT ENCROACHMENT OF VEHICLES OVER THE REQUIRED WIDTH OF WALKWAYS. PARKING STALLS SHALL BE SO LOCATED THAT PERSONS WITH DISABILITIES ARE NOT COMPELLED TO WHEEL OR WALK BEHIND PARKED CARS OTHER THAN THEIR OWN.
- SURFACE SLOPES OF ACCESSIBLE OFF-STREET PARKING STALLS SHALL BE THE MINIMUM POSSIBLE AND SHALL NOT EXCEED 2 PERCENT IN ANY DIRECTION.
- THE REQUIRED NUMBER OF ACCESSIBLE PARKING STALLS IN EACH PARKING LOT SHALL BE 8 MINIMUM.
- WHERE PLAQUE R99B (CA), SIGN R99C (CA) OR SIGN R7-8B ARE INSTALLED, THE BOTTOM OF THE SIGN OR PLAQUE PANEL SHALL BE A MINIMUM OF 6'-8" ABOVE THE SURROUNDING SURFACE.
- CURB RAMP SHALL CONFORM TO THE DETAILS SHOWN ON REVISED STANDARD PLAN RSP A88A.
- NOT USED.
- THE WORDS "NO PARKING", SHALL BE PAINTED IN WHITE LETTERS NO LESS THAN 1'-0" HIGH AND LOCATED SO THAT IT IS VISIBLE TO TRAFFIC ENFORCEMENT OFFICIALS. SEE REVISED STANDARD PLAN RSP A90B FOR DETAILS OF THE "NO PARKING" PAVEMENT MARKING.
- A R100B (CA) SIGN SHALL BE POSTED IN A CONSPICUOUS PLACE AT EACH ENTRANCE TO OFF-STREET PARKING FACILITIES OR IMMEDIATELY ADJACENT TO AND VISIBLE FROM EACH STALL. THE SIGN SHALL INCLUDE THE ADDRESS WHERE THE TOWED VEHICLE MAY BE RECLAIMED AND THE TELEPHONE NUMBER OF THE LOCAL TRAFFIC LAW ENFORCEMENT AGENCY.
- WHERE A SINGLE (NON-VAN) ACCESSIBLE PARKING SPACE IS PROVIDED, THE LOADING AND UNLOADING ACCESS AISLE SHALL BE ON THE PASSENGER SIDE OF THE VEHICLE AS THE VEHICLE IS GOING FORWARD INTO THE PARKING SPACE.
- WHERE A VAN ACCESSIBLE PARKING SPACE IS PROVIDED, THE LOADING AND UNLOADING ACCESS AISLE SHALL BE 8'-0" WIDE MINIMUM, AND SHALL BE ON THE PASSENGER SIDE OF THE VEHICLE AS THE VEHICLE IS GOING FORWARD INTO THE PARKING SPACE.
- ACCESSIBLE PARKING ONLY SIGN SHALL BE SIGN R99C (CA) OR SIGN R99 (CA) WITH PLAQUE R99B (CA).



SIGN R99C (CA)
SEE NOTE 6



SIGN R7-8b
SEE NOTES 2 AND 6



SIGN R100B (CA)
SEE NOTE 10

OFF-STREET PARKING SIGN

N.T.S.
(PARKING LOT)
SEE NOTE 6

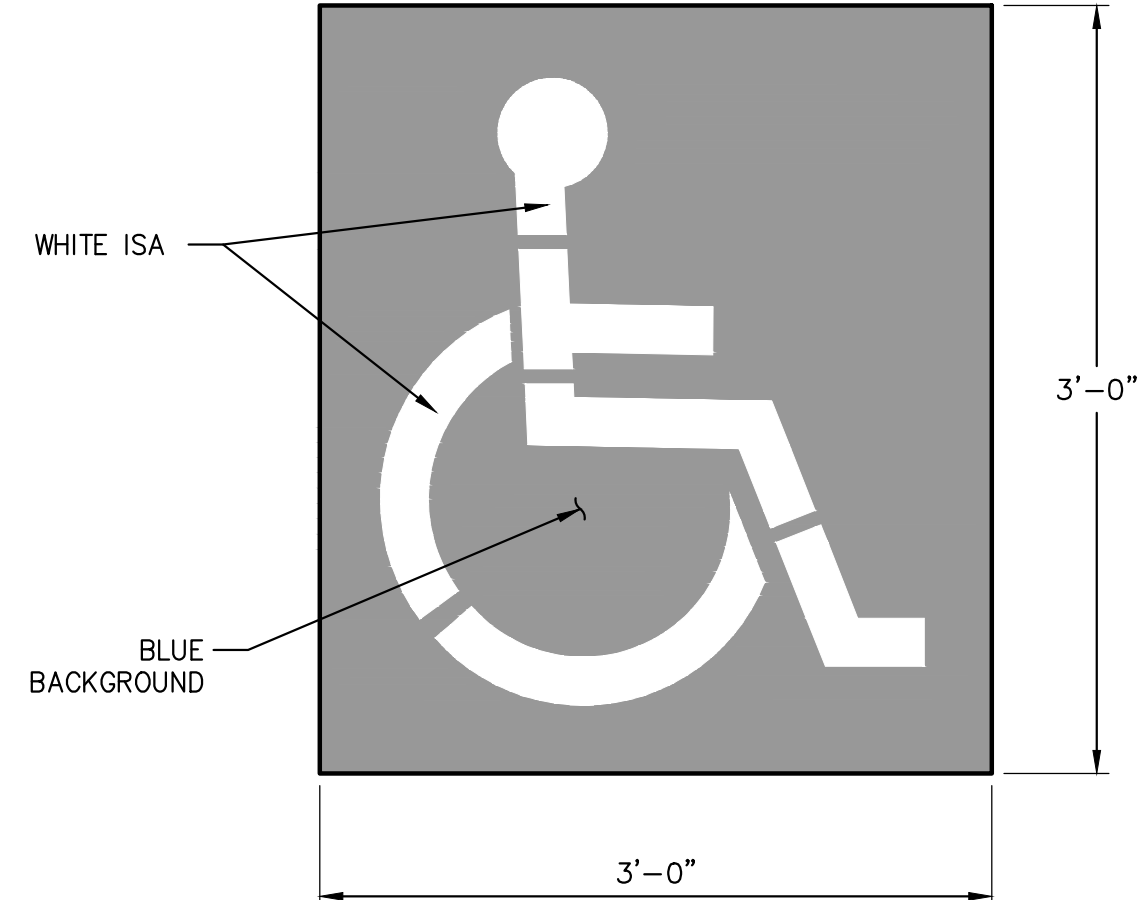

DETAIL 'A'

N. T. S.

ACCESSIBLE PARKING OFF-STREET STD. DWG. NO. A-90A

STATE OF CALIFORNIA DEPARTMENT OF TRANSPORTATION

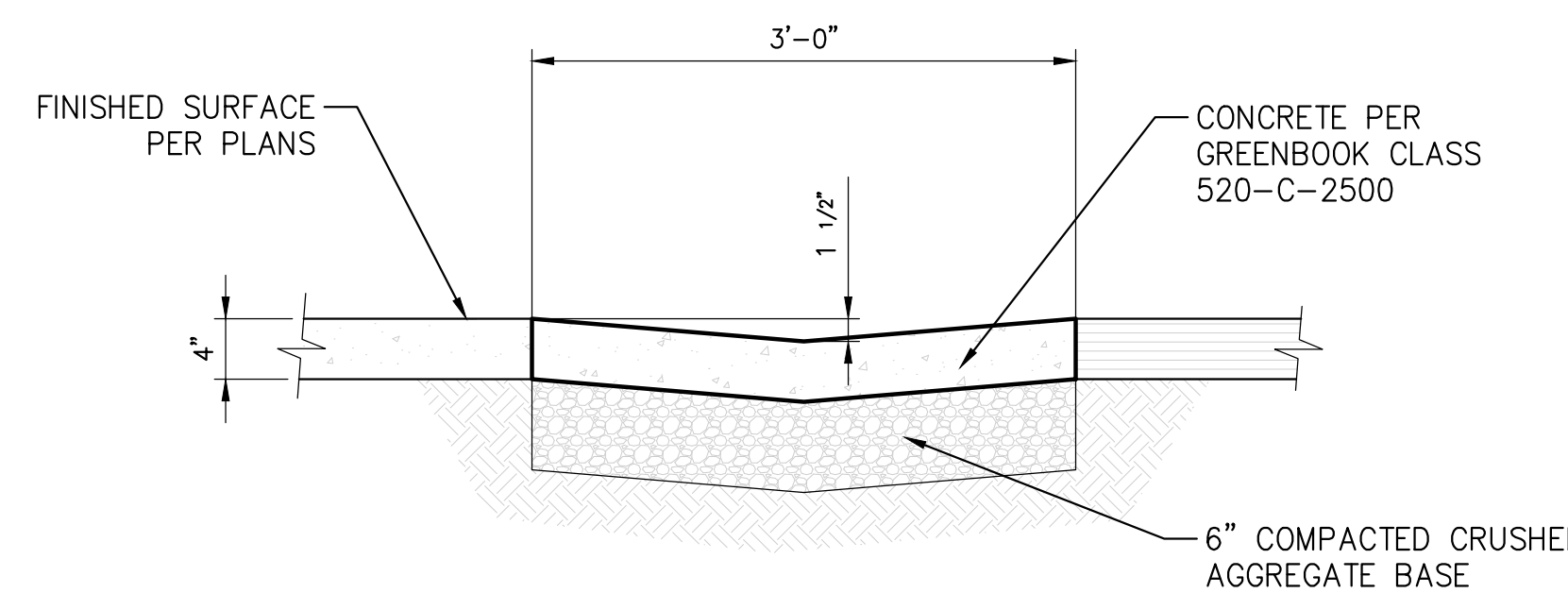

5 RIBBON GUTTER DETAIL 2

N. T. S.

BASIS OF BEARINGS:
BASIS OF BEARINGS IS TAKING ALONG THE MONUMENTED CENTERLINE OF TRADER PLACE DRIVE, BEING N00°00'28"E

C:\Email\Temp\COMDCD\14009_P&P.dwg Jul 06, 2021, 1:05pm

DATE	BY	MARK	APPR.	DATE

ENGINEER	REVISIONS	CITY

DRAWN BY: PV/AM DESIGNED BY: AM/CHG CHECKED BY: CHG

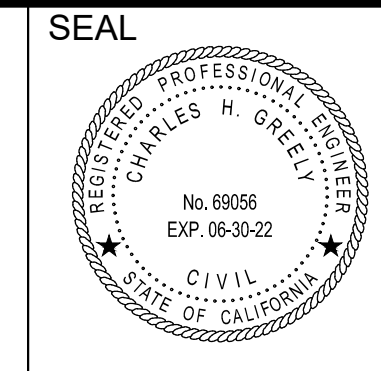

PREPARED UNDER THE SUPERVISION OF:
CHARLES H. GREELY DATE: R.C.E. No. 69056 EXP. DATE: 06/30/22

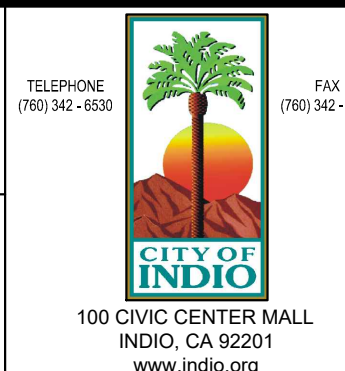

SCALE: AS SHOWN BENCHMARK: (TEMPORARY BENCHMARK)
DATE: June, 2021 CENTER TOP OF EASTERLY CURB OF TRADER PLACE DRIVE AT THE BEGINNING OF CURVE (MARKED WITH A CONG. NAIL) OPPOSITE MAIN ENTRY TO COACHELLA VALLEY MOSQUITO AND VECTOR CONTROL DISTRICT OFFICES.
ELEV. = 505.38 NAVD88

CITY OF INDO, STATE OF CALIFORNIA	SHEET No.
GRADING & PAVING PLANS	4
DETAILS & SECTIONS	OF <input type="checkbox"/> SHTS.
FOR: Coachella Valley Mosquito and Vector Control District	W.O. _____